



TWS500

TOOL TROLLEYS



- Stable steel construction
- The trolley is suitable for setting down welding supports and tools
- Makes organising the workplace easy
- The ideal complement to the 4-head welding machine
- Storage trays for setting down accessories and gasket limitation with plunger or blade
- Five drawers for welding supports
- Four castors, two of which have a fixing brake

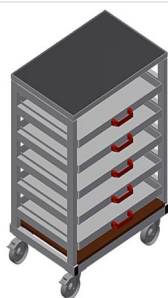

TWS 500 trolley for supports and tools

The trolley is suitable for setting down welding supports and tools



Castors

Four castors, two of which have a fixing brake, provide a high degree of mobility and easy, safe handling

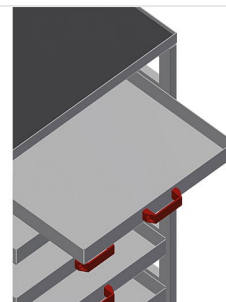

Drawer

Drawer for welding supports and tools

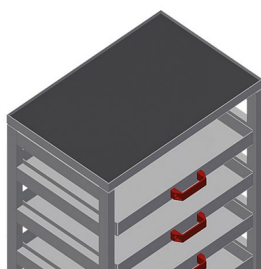

Storage surfaces for accessories

Storage trays for setting down accessories and gasket limitation with plunger or blade



TWS 500 / TOOL TROLLEYS

- Length 760 mm
- Width 520 mm
- Vertical height 1,095 mm
- Weight 60 kg
- Roller diameter 125 mm